

24

October 8, 2012

The Director (Planning) MPRTC,  
Delhi Development Authority,  
6<sup>th</sup> Floor, Vikas Minar  
New Delhi

Director (Plan) MPRTC,  
D.D.A. Vikas Minar Q. DELHI-2  
Dy.No. L-166  
Date 18/10/12

**RE: Parking of our House no. A-1/311, Safdarjung Enclave**

Dear Sir,

With reference to the above, we wish to bring to your kind notice that the above mentioned plot was purchased by us in open auction held by DDA in the year 1981 and at that time, the site plan (photocopy enclosed) given to us shows a designated parking area at the northern end of the plot which is also the part of our perpetual lease deed. This plot was subsequently made freehold in the year 1994.

In the recent past the parking given to us as per site plan of the auction of the plot has been converted into a park. **Since we had bought this plot on the basis of the original site plan advertised by the DDA denoting the parking at the Northern end of the plot our request is that the DDA should reinstate the parking and provide us with the original status of the plot as it was at the time of auction as we are facing acute crisis for parking our vehicles due to this conversion.**

Thanking You

Yours Faithfully,  
for UMA GUPTA



VINOD GUPTA  
(Husband)

Plant  
11/10

ADRS III

Encl:

1. Copy of site plan received from DDA
2. Copy of the original DDA Layout plan and the subsequent changes.



4(CG)A

LDP

# दिल्ली विकास प्राधिकरण Delhi Development Authority

प्लान नाम SAFDARYUNG  
SCHEME RES.  
भूमि प्रयोग -  
LAND USE

प्लॉट नं० 311  
Plot No.

ब्लॉक नं० A-1  
Block No.  
दिल्ली 1  
DELHI.

स्केल  
Scale

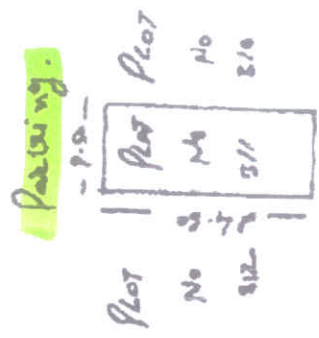

Verified

*[Signature]*  
2/6

क्षेत्र / Area 9.60 x 24.30 वर्ग-मीटर/वर्ग मीटर  
Sq. Mts./Sq. Mts. = 230.88

पट्टाधार/वरीधार  
LESSOR/VENDOR

दिल्ली विकास प्राधिकरण नई दिल्ली  
Delhi Development Authority  
पट्टाधार/विक्रेते वाला  
LESSOR/VENDOR

DDA/PP.





DETAIL PLAN OF (X)

NOT TO SCALE

CHANGING LAYOUT

only for office use

TOTAL AREA OF THE SCHEME = 90.0 ACS.  
= 36.04 HACT.